

Qty.	Description
1	<p data-bbox="199 340 534 362">NB 50-125/144 ASF2ABQQE</p> <div data-bbox="215 403 566 638">  </div> <p data-bbox="590 631 1077 654" style="text-align: center;">Note! Product picture may differ from actual product</p> <p data-bbox="199 663 470 685">Product No.: 98781395</p> <p data-bbox="199 721 1460 775">Non-self-priming, single-stage, centrifugal volute pump designed according to ISO 5199 with dimensions and rated performance according to EN 733 (10 bar).</p> <p data-bbox="199 810 1460 887">Flanges are PN 16 with dimensions according to EN 1092-2. The pump has an axial suction port, radial discharge port, horizontal shaft and a back pull-out design enabling removal of the motor, motor stool, cover and impeller without disturbing the pump housing or pipework.</p> <p data-bbox="199 900 941 922">The unbalanced rubber bellows seal is according to DIN EN 12756.</p> <p data-bbox="199 927 909 949">The pump is close-coupled to a fan-cooled asynchronous motor.</p> <p data-bbox="199 985 311 1008">Controls:</p> <p data-bbox="199 1012 638 1034">Frequency converter: NONE</p> <p data-bbox="199 1070 287 1093">Liquid:</p> <p data-bbox="199 1097 638 1120">Pumped liquid: Water</p> <p data-bbox="199 1124 710 1146">Liquid temperature range: -25 .. 120 °C</p> <p data-bbox="199 1151 686 1173">Liquid temperature during operation: 20 °C</p> <p data-bbox="199 1178 702 1200">Density: 998.2 kg/m³</p> <p data-bbox="199 1236 327 1258">Technical:</p> <p data-bbox="199 1263 678 1285">Rated flow: 80.5 m³/h</p> <p data-bbox="199 1290 662 1312">Rated head: 22.35 m</p> <p data-bbox="199 1317 662 1339">Actual impeller diameter: 144 mm</p> <p data-bbox="199 1344 662 1366">Nominal impeller diameter: 125 mm</p> <p data-bbox="199 1370 638 1393">Shaft seal arrangement: Single</p> <p data-bbox="199 1397 638 1420">Code for shaft seal: BQQE</p> <p data-bbox="199 1424 766 1447">Curve tolerance: ISO9906:2012 3B</p> <p data-bbox="199 1482 319 1505">Materials:</p> <p data-bbox="199 1509 734 1599">Pump housing: Cast iron EN-GJL-250 ASTM class 35</p> <p data-bbox="199 1603 638 1626">Wear ring: Brass</p> <p data-bbox="199 1630 734 1720">Impeller: Cast iron EN-GJL-200 ASTM class 30</p> <p data-bbox="199 1724 734 1814">Shaft: Stainless steel EN 1.4301 AISI 304</p> <p data-bbox="199 1850 343 1872">Installation:</p> <p data-bbox="199 1877 638 1899">Maximum ambient temperature: 60 °C</p> <p data-bbox="199 1904 638 1926">Maximum operating pressure: 16 bar</p> <p data-bbox="199 1930 686 1953">Pipe connection standard: EN 1092-2</p> <p data-bbox="199 1957 638 1980">Size of inlet connection: DN 65</p> <p data-bbox="199 1984 638 2007">Size of outlet connection: DN 50</p> <p data-bbox="199 2011 686 2033">Pressure rating for pipe connection: PN 16</p> <p data-bbox="199 2038 582 2060">Pump housing with feet: Y</p>

Qty.	Description
	<p>Support block: Y</p> <p>Electrical data:</p> <p>IE Efficiency class: IE3</p> <p>P2: 7.5 kW</p> <p>Mains frequency: 50 Hz</p> <p>Rated voltage: 3 x 380-415D/660-690Y V</p> <p>Rated current: 14,4-14,0/8,30-8,10 A</p> <p>Starting current: 780-910 %</p> <p>Cos phi - power factor: 0.88-0.86</p> <p>Rated speed: 2910-2920 rpm</p> <p>Efficiency: IE3 90,1% - IE3 90,4%</p> <p>Motor efficiency at full load: 90.1-90.4 %</p> <p>Motor efficiency at 3/4 load: 90.8 %</p> <p>Motor efficiency at 1/2 load: 90.8 %</p> <p>Number of poles: 2</p> <p>Enclosure class (IEC 34-5): 55 Dust/Jetting</p> <p>Insulation class (IEC 85): F</p> <p>Others:</p> <p>Minimum efficiency index, MEI $\hat{\alpha}\%_{\alpha}$: 0.70</p> <p>Net weight: 91 kg</p> <p>Gross weight: 112 kg</p> <p>Shipping volume: 0.509 m³</p> <p>Country of origin: HU</p> <p>Custom tariff no.: 84137051</p>

98781395 NB 50-125/144 ASF2ABQQE 50 Hz

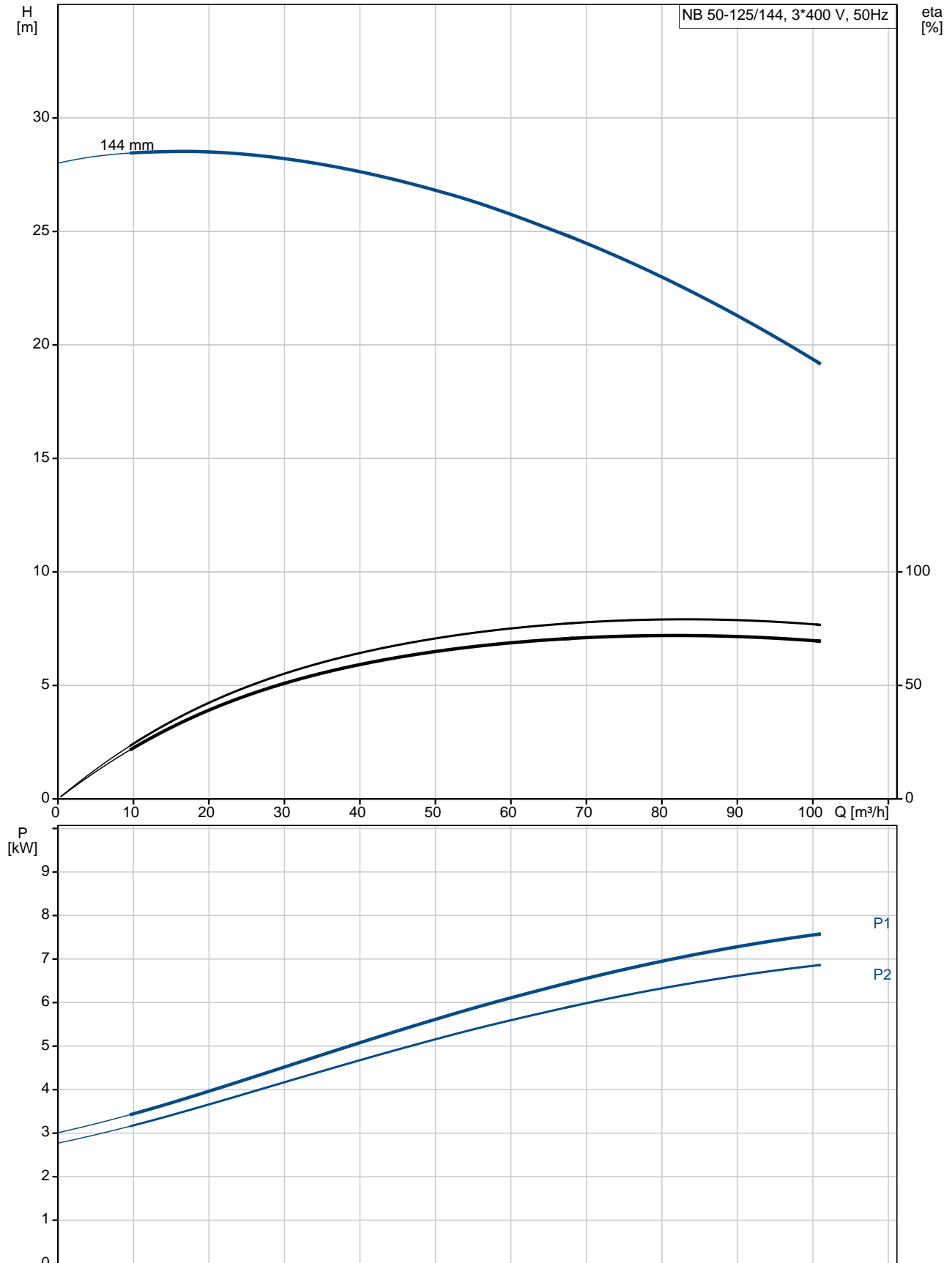

Description	Value
-------------	-------

General information:

Product name: NB 50-125/144 ASF2ABQQE

Product No: 98781395

EAN number: 5712601311946

Price: 2.429,00 GBP

Technical:

Rated flow: 80.5 m³/h

Rated head: 22.35 m

Actual impeller diameter: 144 mm

Nominal impeller diameter: 125 mm

Shaft seal arrangement: Single

Shaft diameter: 24 mm

Code for shaft seal: BQQE

Curve tolerance: ISO9906:2012 3B

Pump version: AS

Materials:

Pump housing: Cast iron
EN-GJL-250
ASTM class 35

Wear ring: Brass

Impeller: Cast iron
EN-GJL-200
ASTM class 30

Shaft: Stainless steel
EN 1.4301
AISI 304

Material code: A

Installation:

Maximum ambient temperature: 60 °C

Maximum operating pressure: 16 bar

Pipe connection standard: EN 1092-2

Size of inlet connection: DN 65

Size of outlet connection: DN 50

Pressure rating for pipe connection: PN 16

Pump housing with feet: Y

Support block: Y

Connect code: F2

Liquid:

Pumped liquid: Water

Liquid temperature range: -25 .. 120 °C

Liquid temperature during operation: 20 °C

Density: 998.2 kg/m³

Electrical data:

IE Efficiency class: IE3

P2: 7.5 kW

Mains frequency: 50 Hz

Rated voltage: 3 x 380-415D/660-690Y V

Rated current: 14,4-14,0/8,30-8,10 A

Starting current: 780-910 %

Cos phi - power factor: 0.88-0.86

Rated speed: 2910-2920 rpm

Efficiency: IE3 90,1% - IE3 90,4%

Motor efficiency at full load: 90.1-90.4 %

Motor efficiency at 3/4 load: 90.8 %

Motor efficiency at 1/2 load: 90.8 %

Number of poles: 2

Enclosure class (IEC 34-5): 55 Dust/Jetting

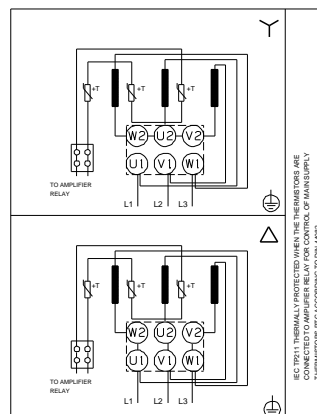
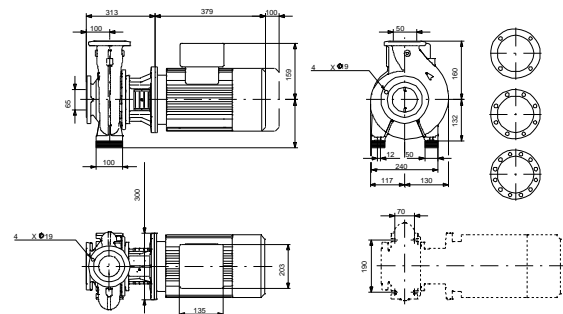
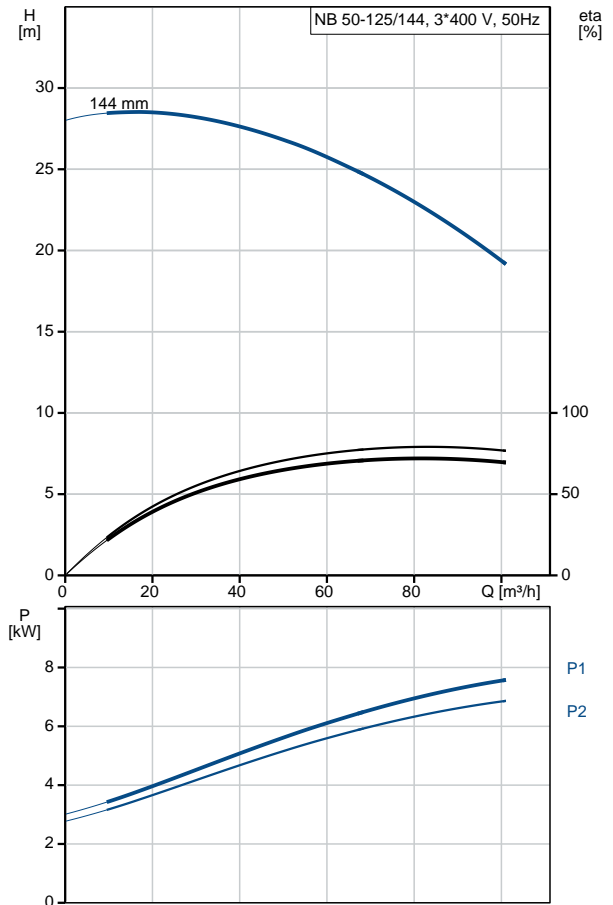



Company name:

Created by:

Phone:

Date:

21/03/2019

Description	Value
Insulation class (IEC 85):	F
Motor protec:	PTC
Motor No:	87370232
Mount. design. acc. IEC 34-7:	IM V1/B5
Controls:	
Frequency converter:	NONE
Others:	
Minimum efficiency index, MEI $\eta_{\%}$:	0.70
Net weight:	91 kg
Gross weight:	112 kg
Shipping volume:	0.509 m ³
Country of origin:	HU
Custom tariff no.:	84137051

98781395 NB 50-125/144 ASF2ABQQE 50 Hz

