

Qty.	Description
1	<p data-bbox="199 338 510 367"><b>MTR 64-8/8-1 A-F-A-HUUV</b></p>  <p data-bbox="199 660 470 689">Product No.: <a href="#">98513756</a></p> <p data-bbox="199 719 1173 779">Multistage, immersible, self-priming, centrifugal pump for vertical installation in tanks etc. The pump head and base are in cast iron – all other wetted parts are in stainless steel. The pump has the following characteristics:</p> <ul data-bbox="239 808 1141 929" style="list-style-type: none"> <li>• Installation length according to DIN 5440.</li> <li>• Impellers, intermediate chambers and spline shaft are made of Stainless steel.</li> <li>• Mechanical shaft seal according to EN 12756.</li> <li>• Power transmission via cast-iron split coupling.</li> </ul> <p data-bbox="199 958 1189 987">A cartridge shaft seal ensures high reliability, safe handling, and easy access and service.</p> <p data-bbox="199 1077 638 1137"><b>Controls:</b> Frequency converter: NONE</p> <p data-bbox="199 1167 774 1317"><b>Liquid:</b> Pumped liquid: Water Liquid temperature range: -10 .. 90 °C Selected liquid temperature: 20 °C Density at selected liquid temperature: 998.2 kg/m<sup>3</sup></p> <p data-bbox="199 1346 821 1615"><b>Technical:</b> Pump speed on which pump data are based: 2960 rpm Rated flow: 64 m<sup>3</sup>/h Rated head: 181.3 m Chambers: 8 Drainage back to tank: N Pump orientation: Vertical Code for shaft seal: HUUV Curve tolerance: ISO9906:2012 3B</p> <p data-bbox="199 1644 805 1854"><b>Materials:</b> Pump head: Cast iron EN 1561 EN-GJL-200 ASTM A48-25B Impeller: Stainless steel EN 1.4301 AISI 304</p> <p data-bbox="199 1883 726 2085"><b>Installation:</b> Maximum ambient temperature: 55 °C Maximum operating pressure: 25 bar Max pressure at stated temp: 25 bar / 90 °C Type of connection: DIN Size of outlet connection: DN 80 Immersion depth: 744 mm</p>

Qty.	Description
	<p>Pressure rating for pipe connection: PN 40            Flange size for motor: FF400</p> <p><b>Electrical data:</b>            Motor standard: IEC            Motor type: SIEMENS            IE Efficiency class: IE3            Rated power - P2: 45 kW            Mains frequency: 50 Hz            Rated voltage: 3 x 380-420D/660-725Y V            Rated current: 81,0-74,0/47,0-43,0 A            Starting current: 690-690 %            Cos phi - power factor: 0.89            Rated speed: 2960 rpm            Efficiency: IE3 94,0%            Motor efficiency at full load: 94.0-94.0 %            Motor efficiency at 3/4 load: 94.5-94.5 %            Motor efficiency at 1/2 load: 94.4-94.4 %            Number of poles: 2            Enclosure class (IEC 34-5): 55 Dust/Jetting            Insulation class (IEC 85): F            Motor No: 81U15336</p> <p><b>Others:</b>            Terminal box position: 6            Minimum efficiency index, MEI : 0.70            Net weight: 411 kg            Gross weight: 469 kg            Shipping volume: 0.81 m<sup>3</sup>            Country of origin: HU            Custom tariff no.: 84137075</p>

## 98513756 MTR 64-8/8-1 A-F-A-HUUV 50 Hz

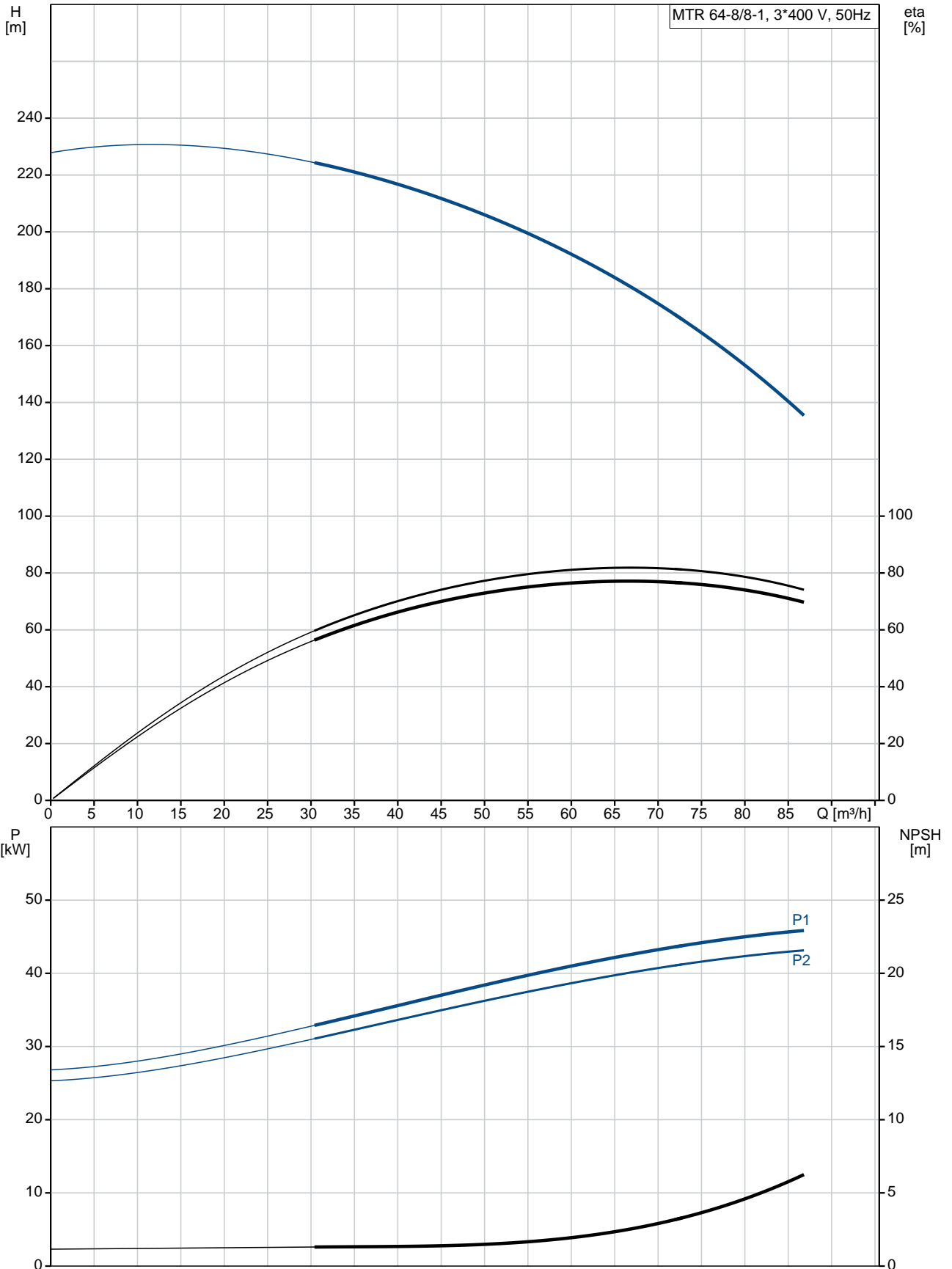

Description	Value
<b>General information:</b>	
Product name:	MTR 64-8/8-1 A-F-A-HUUV
Product No:	98513756
EAN number:	5711496395024 5711496395024
<b>Technical:</b>	
Pump speed on which pump data are based:	2960 rpm
Rated flow:	64 m <sup>3</sup> /h
Rated head:	181.3 m
Chambers:	8
Impellers:	8
Number of reduced-diameter impellers:	1
Drainage back to tank:	N
Pump orientation:	Vertical
Code for shaft seal:	HUUV
Curve tolerance:	ISO9906:2012 3B
Pump version:	A
Model:	B
<b>Materials:</b>	
Pump head:	Cast iron EN 1561 EN-GJL-200 ASTM A48-25B
Impeller:	Stainless steel EN 1.4301 AISI 304
Material code:	A
<b>Installation:</b>	
Maximum ambient temperature:	55 °C
Maximum operating pressure:	25 bar
Max pressure at stated temp:	25 bar / 90 °C
Type of connection:	DIN
Size of outlet connection:	DN 80
Immersion depth:	744 mm
Pressure rating for pipe connection:	PN 40
Flange size for motor:	FF400
Connect code:	F
<b>Liquid:</b>	
Pumped liquid:	Water
Liquid temperature range:	-10 .. 90 °C
Selected liquid temperature:	20 °C
Density at selected liquid temperature:	998.2 kg/m <sup>3</sup>
<b>Electrical data:</b>	
Motor standard:	IEC
Motor type:	SIEMENS
IE Efficiency class:	IE3
Rated power - P2:	45 kW
Mains frequency:	50 Hz
Rated voltage:	3 x 380-420D/660-725Y V
Rated current:	81,0-74,0/47,0-43,0 A
Starting current:	690-690 %
Cos phi - power factor:	0.89
Rated speed:	2960 rpm
Efficiency:	IE3 94,0%
Motor efficiency at full load:	94.0-94.0 %
Motor efficiency at 3/4 load:	94.5-94.5 %
Motor efficiency at 1/2 load:	94.4-94.4 %

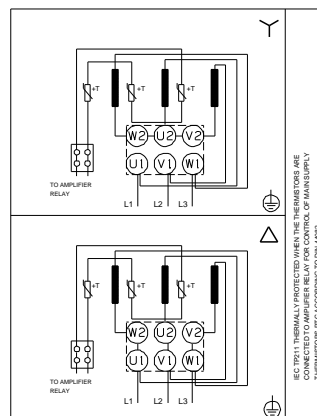
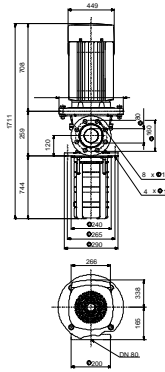
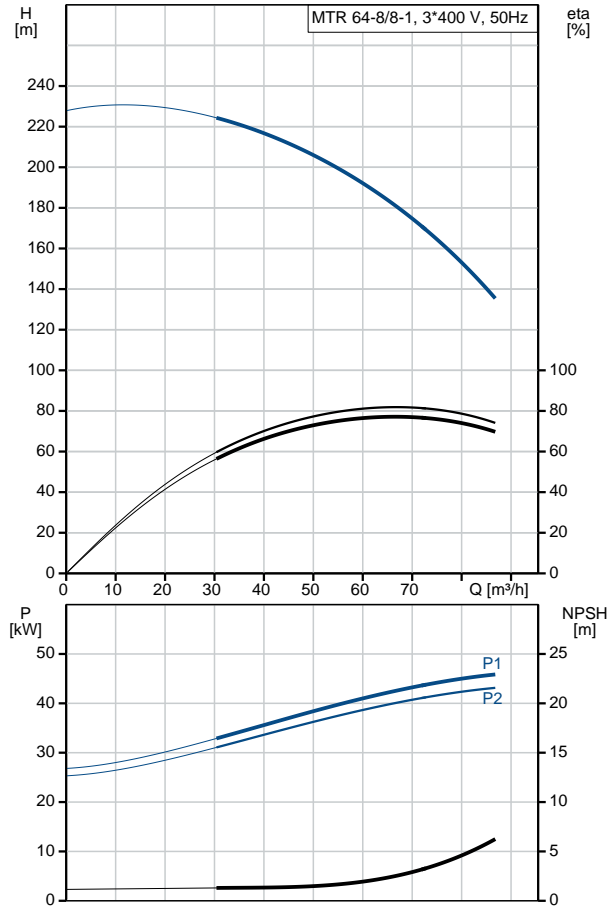



Company name:

Created by:

Phone:

Date:

15/10/2019

Description	Value
Number of poles:	2
Enclosure class (IEC 34-5):	55 Dust/Jetting
Insulation class (IEC 85):	F
Motor protec:	PTC
Motor No:	81U15336
<b>Controls:</b>	
Frequency converter:	NONE
<b>Others:</b>	
Terminal box position:	6
Minimum efficiency index, MEI :	0.70
Net weight:	411 kg
Gross weight:	469 kg
Shipping volume:	0.81 m <sup>3</sup>
Country of origin:	HU
Custom tariff no.:	84137075