

Qty.	Description
1	<p data-bbox="199 338 539 367">NB 32-125.1/110 AF2ABQQE</p> <div data-bbox="296 454 507 600" style="text-align: center;">  </div> <p data-bbox="199 660 469 689">Product No.: 98052673</p> <p data-bbox="199 719 1461 772">Non-self-priming, single-stage, centrifugal volute pump designed according to ISO 5199 with dimensions and rated performance according to EN 733 (10 bar).</p> <p data-bbox="199 806 1452 884">Flanges are PN 16 with dimensions according to EN 1092-2. The pump has an axial suction port, radial discharge port, horizontal shaft and a back pull-out design enabling removal of the motor, motor stool, cover and impeller without disturbing the pump housing or pipework.</p> <p data-bbox="199 896 943 925">The unbalanced rubber bellows seal is according to DIN EN 12756.</p> <p data-bbox="199 925 908 954">The pump is close-coupled to a fan-cooled asynchronous motor.</p> <p data-bbox="199 983 316 1012">Controls:</p> <p data-bbox="199 1012 638 1041">Frequency converter: NONE</p> <p data-bbox="199 1070 288 1099">Liquid:</p> <p data-bbox="199 1099 635 1128">Pumped liquid: Water</p> <p data-bbox="199 1128 707 1158">Liquid temperature range: -25 .. 120 °C</p> <p data-bbox="199 1158 687 1187">Liquid temperature during operation: 20 °C</p> <p data-bbox="199 1187 699 1216">Density: 998.2 kg/m³</p> <p data-bbox="199 1245 328 1274">Technical:</p> <p data-bbox="199 1274 673 1303">Rated flow: 16.9 m³/h</p> <p data-bbox="199 1303 644 1332">Rated head: 11.8 m</p> <p data-bbox="199 1332 657 1361">Actual impeller diameter: 110 mm</p> <p data-bbox="199 1361 678 1391">Nominal impeller diameter: 125.1 mm</p> <p data-bbox="199 1391 636 1420">Shaft seal arrangement: Single</p> <p data-bbox="199 1420 638 1449">Code for shaft seal: BQQE</p> <p data-bbox="199 1449 764 1478">Curve tolerance: ISO9906:2012 3B</p> <p data-bbox="199 1507 320 1536">Materials:</p> <p data-bbox="199 1536 735 1632">Pump housing: Cast iron EN-GJL-250 ASTM class 35</p> <p data-bbox="199 1632 632 1662">Wear ring: Brass</p> <p data-bbox="199 1662 735 1758">Impeller: Cast iron EN-GJL-200 ASTM class 30</p> <p data-bbox="199 1758 729 1854">Shaft: Stainless steel EN 1.4301 AISI 304</p> <p data-bbox="199 1883 344 1912">Installation:</p> <p data-bbox="199 1912 632 1942">Maximum ambient temperature: 60 °C</p> <p data-bbox="199 1942 639 1971">Maximum operating pressure: 16 bar</p> <p data-bbox="199 1971 687 2000">Pipe connection standard: EN 1092-2</p> <p data-bbox="199 2000 639 2029">Size of inlet connection: DN 50</p> <p data-bbox="199 2029 639 2058">Size of outlet connection: DN 32</p> <p data-bbox="199 2058 687 2087">Pressure rating for pipe connection: PN 16</p> <p data-bbox="199 2087 584 2116">Pump housing with feet: Y</p>

Qty.	Description
	<p>Support block: N</p> <p>Electrical data:</p> <p>IE Efficiency class: IE3</p> <p>P2: 1.1 kW</p> <p>Mains frequency: 50 Hz</p> <p>Rated voltage: 3 x 220-240D/380-415Y V</p> <p>Rated current: 4.35/2.50 A</p> <p>Starting current: 450-500 %</p> <p>Cos phi - power factor: 0.83-0.76</p> <p>Rated speed: 2840-2870 rpm</p> <p>Efficiency: IE3 82,7%</p> <p>Motor efficiency at full load: 82.7 %</p> <p>Motor efficiency at 3/4 load: 84.6 %</p> <p>Motor efficiency at 1/2 load: 85.4 %</p> <p>Number of poles: 2</p> <p>Enclosure class (IEC 34-5): 55 Dust/Jetting</p> <p>Insulation class (IEC 85): F</p> <p>Others:</p> <p>Minimum efficiency index, MEI $\hat{\alpha}\%$: 0.70</p> <p>Net weight: 34 kg</p> <p>Gross weight: 45 kg</p> <p>Shipping volume: 0.134 m³</p> <p>Country of origin: HU</p> <p>Custom tariff no.: 84137051</p>

98052673 NB 32-125.1/110 AF2ABQQE 50 Hz

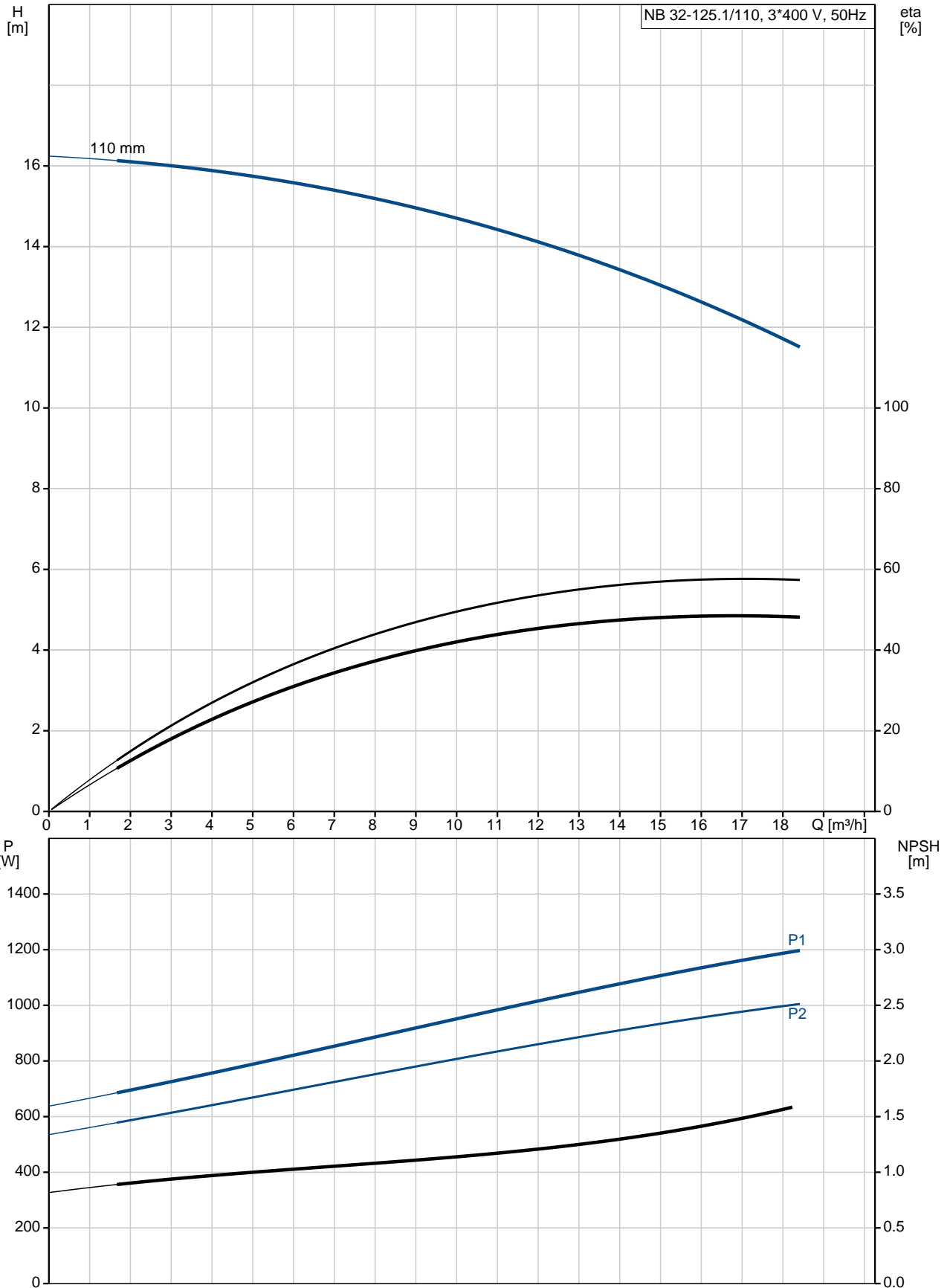

Description	Value
-------------	-------

General information:

Product name: NB 32-125.1/110 AF2ABQQE

Product No: 98052673

EAN number: 5710628156236

Price: 1.188,00 GBP

Technical:

Rated flow: 16.9 m³/h

Rated head: 11.8 m

Actual impeller diameter: 110 mm

Nominal impeller diameter: 125.1 mm

Shaft seal arrangement: Single

Shaft diameter: 24 mm

Code for shaft seal: BQQE

Curve tolerance: ISO9906:2012 3B

Pump version: A

Materials:

Pump housing: Cast iron

EN-GJL-250

ASTM class 35

Wear ring: Brass

Impeller: Cast iron

EN-GJL-200

ASTM class 30

Shaft: Stainless steel

EN 1.4301

AISI 304

Material code: A

Installation:

Maximum ambient temperature: 60 °C

Maximum operating pressure: 16 bar

Pipe connection standard: EN 1092-2

Size of inlet connection: DN 50

Size of outlet connection: DN 32

Pressure rating for pipe connection: PN 16

Pump housing with feet: Y

Support block: N

Connect code: F2

Liquid:

Pumped liquid: Water

Liquid temperature range: -25 .. 120 °C

Liquid temperature during operation: 20 °C

Density: 998.2 kg/m³

Electrical data:

IE Efficiency class: IE3

P2: 1.1 kW

Mains frequency: 50 Hz

Rated voltage: 3 x 220-240D/380-415Y V

Rated current: 4.35/2.50 A

Starting current: 450-500 %

Cos phi - power factor: 0.83-0.76

Rated speed: 2840-2870 rpm

Efficiency: IE3 82,7%

Motor efficiency at full load: 82.7 %

Motor efficiency at 3/4 load: 84.6 %

Motor efficiency at 1/2 load: 85.4 %

Number of poles: 2

Enclosure class (IEC 34-5): 55 Dust/Jetting

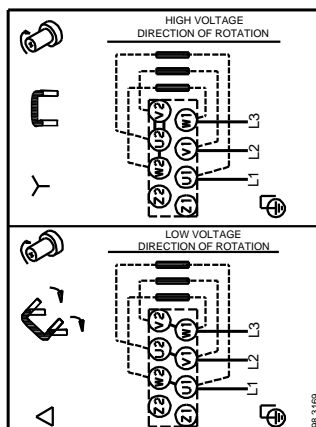
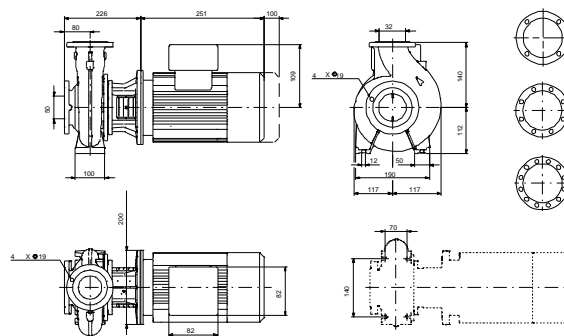
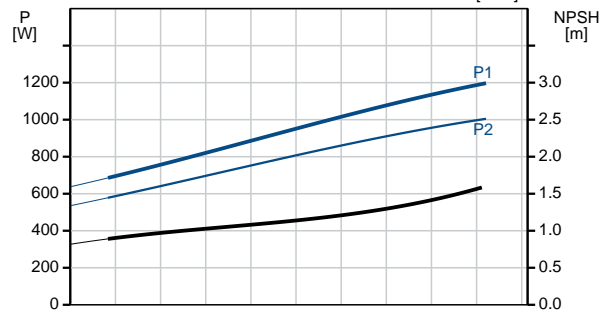
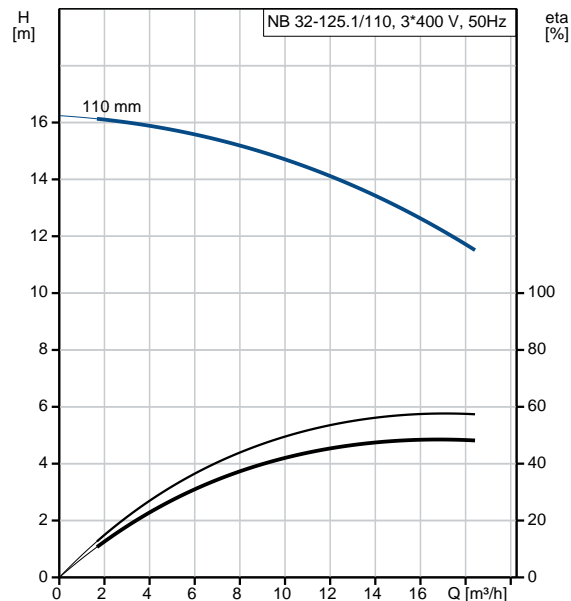



Company name:

Created by:

Phone:

Date:

21/03/2019

Description	Value
Insulation class (IEC 85):	F
Motor protec:	NONE
Motor No:	87120286
Mount. design. acc. IEC 34-7:	IM V1/B5
Controls:	
Frequency converter:	NONE
Others:	
Minimum efficiency index, MEI $\eta_{\%}$:	0.70
Net weight:	34 kg
Gross weight:	45 kg
Shipping volume:	0.134 m ³
Country of origin:	HU
Custom tariff no.:	84137051

98052673 NB 32-125.1/110 AF2ABQQE 50 Hz

