

**Qty. Description**

1 **SP 360-3L G**



**Note! Product picture may differ from actual product**

Product No.: [96431011](#)

Multi-stage submersible pump for raw water supply, groundwater lowering, pressure boosting and various industrial jobs.

The pump is suitable for pumping clean, thin, non-aggressive liquids without solid particles or fibres.

**Pump:** The pump is made entirely of Cast iron DIN W.-Nr. EN-JL1040 and suitable for horizontal installation.

The pump is fitted with a built-in non-return valve.

**Phase:** The motor is a 3-phase motor with sand shield, liquid-lubricated bearings and pressure equalizing diaphragm.

Performance test according to ISO9906 2012 Grade 3B is available on request.

**Liquid:**

Pumped liquid: Water  
 Maximum liquid temperature: 40 °C  
 Max liquid t at 0.15 m/sec: 25 °C  
 Selected liquid temperature: 20 °C  
 Density: 998.2 kg/m<sup>3</sup>

**Technical:**

Type of impeller: L  
 Shaft seal for motor: CER/CARBON  
 Curve tolerance: ISO9906:2012 3B  
 Motor version: T30

**Materials:**

**Pump:** Cast iron  
 EN-JL1040  
**Impeller:** Zinc-free bronze  
 DIN W.-Nr. 2.1050.01  
**Motor:** Cast iron  
 DIN W.-Nr. 0.6025  
 ASTM 35-40

**Installation:**

Flange standard: DIN  
 Pump outlet: DN175  
 Motor diameter: 10 inch

**Electrical data:**

Motor type: MMS10000  
 Rated power - P2: 110 kW  
 Mains frequency: 50 Hz



Company name:

Created by:

Phone:

Date:

12/11/2020

Qty.	Description
	<p>Rated voltage: 3 x 380-400-415 V Rated current: 232-228-228 A Cos phi - power factor: 0.86-0.84-0.81 Rated speed: 2900-2910-2920 rpm Start. method: direct-on-line Enclosure class (IEC 34-5): IP68 Built-in temp. transmitter: no Motor No: 96430679 Windings: PVC</p> <p>Others: Net weight: 580 kg Shipping volume: 0.624 m<sup>3</sup> Country of origin: IT Custom tariff no.: 84137029</p>

## 96431011 SP 360-3L G 50 Hz

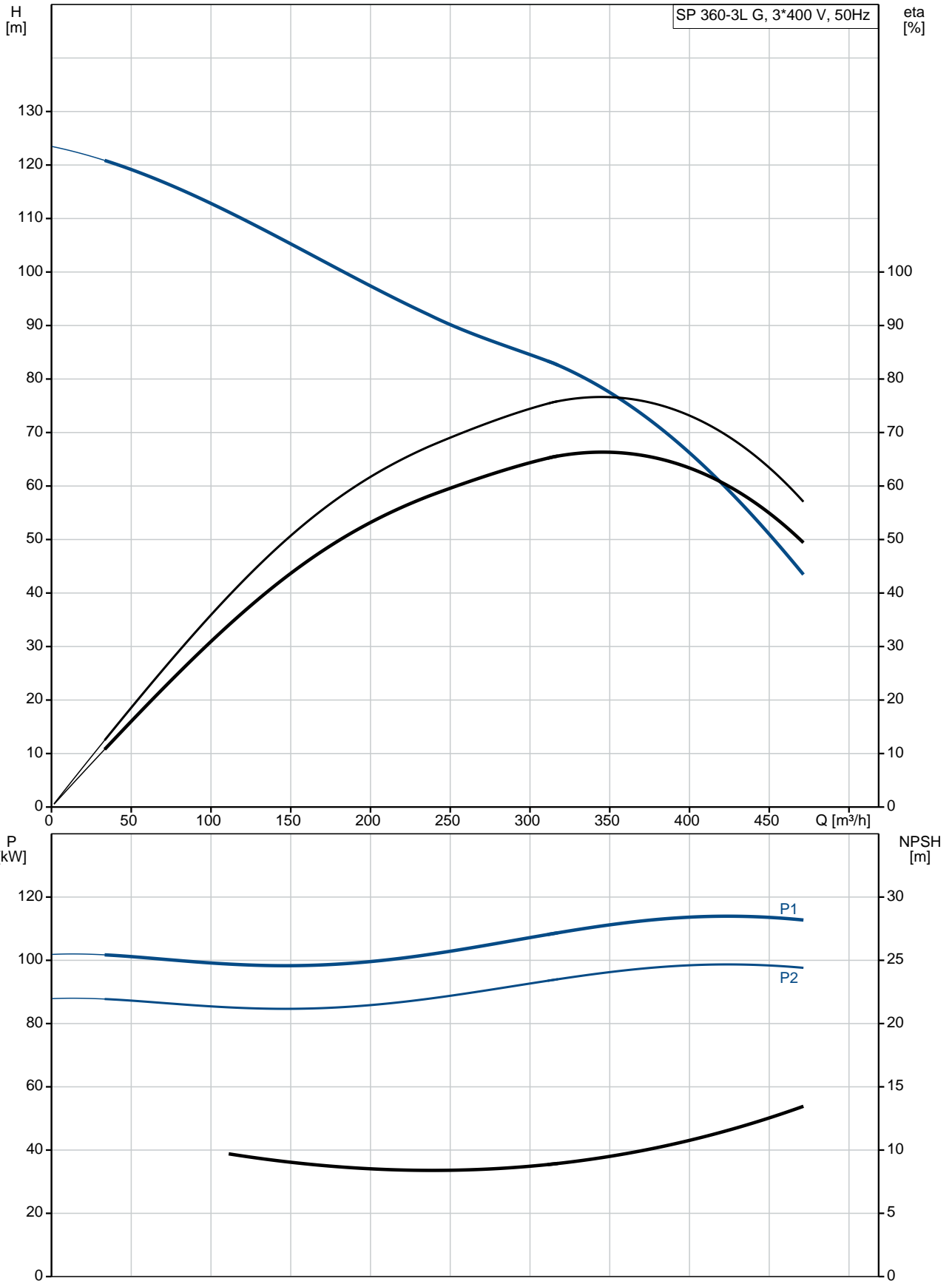

Description	Value
<b>General information:</b>	
Product name:	SP 360-3L G
Product No:	96431011
EAN number:	5700393033467
<b>Technical:</b>	
Stages:	3
Type of impeller:	L
Shaft seal for motor:	CER/CARBON
Curve tolerance:	ISO9906:2012 3B
Pump No:	96430913
Valve:	pump with built-in non-return valve
Motor version:	T30
<b>Materials:</b>	
Pump:	Cast iron
Pump:	EN-JL1040
Impeller:	Zinc-free bronze
Impeller:	DIN W.-Nr. 2.1050.01
Motor:	Cast iron
Motor:	DIN W.-Nr. 0.6025
Motor:	ASTM 35-40
<b>Installation:</b>	
Flange standard:	DIN
Pump outlet:	DN175
Motor diameter:	10 inch
<b>Liquid:</b>	
Pumped liquid:	Water
Maximum liquid temperature:	40 °C
Max liquid t at 0.15 m/sec:	25 °C
Selected liquid temperature:	20 °C
Density:	998.2 kg/m <sup>3</sup>
<b>Electrical data:</b>	
Motor type:	MMS10000
Applic. motor:	GRUNDFOS
Rated power - P2:	110 kW
Mains frequency:	50 Hz
Rated voltage:	3 x 380-400-415 V
Rated current:	232-228-228 A
Cos phi - power factor:	0.86-0.84-0.81
Rated speed:	2900-2910-2920 rpm
Start. method:	direct-on-line
Enclosure class (IEC 34-5):	IP68
Motor protec:	NONE
Thermal protec:	external
Built-in temp. transmitter:	no
Motor No:	96430679
Windings:	PVC
<b>Others:</b>	
Net weight:	580 kg
Shipping volume:	0.624 m <sup>3</sup>
Country of origin:	IT
Custom tariff no.:	84137029

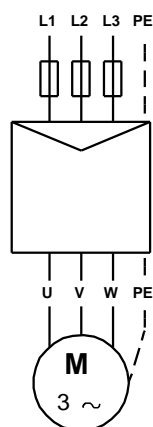
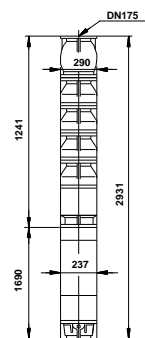
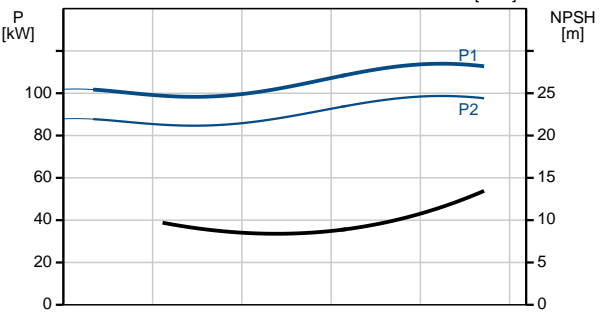
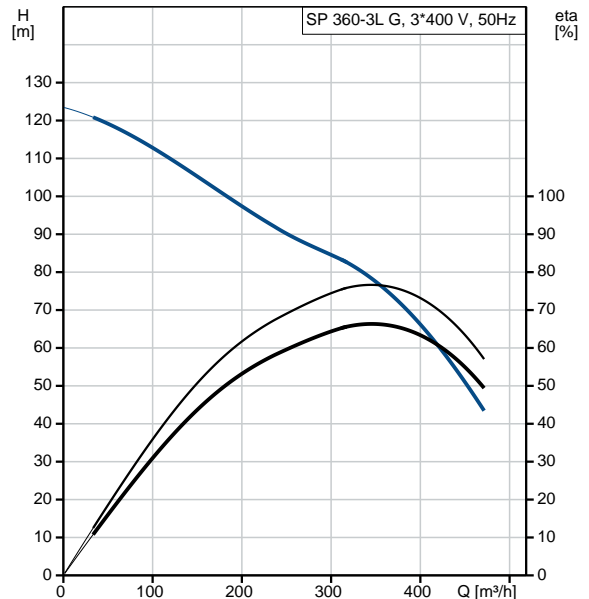

## 96431011 SP 360-3L G 50 Hz

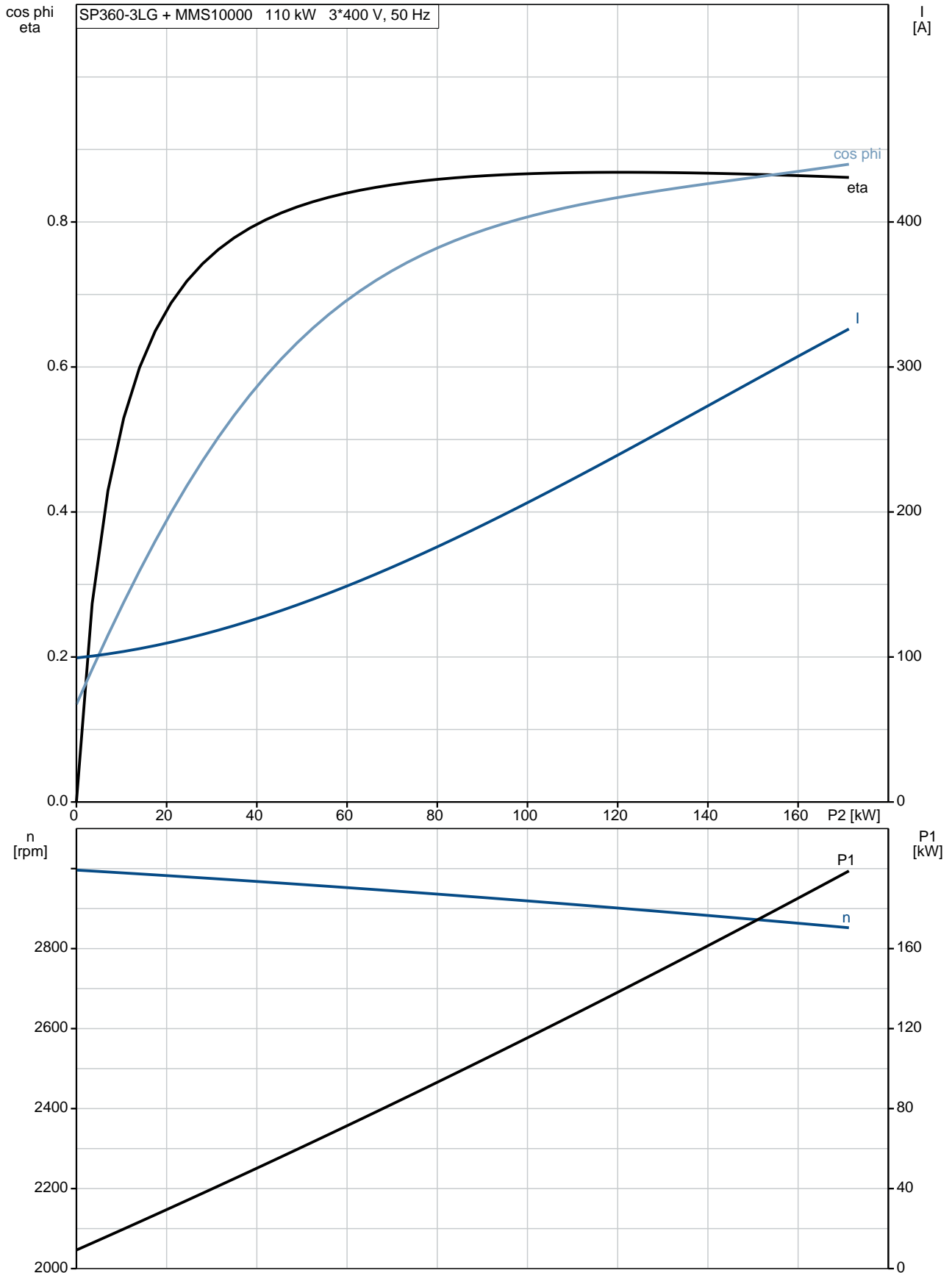

## 96431011 SP 360-3L G 50 Hz

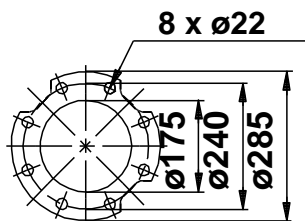
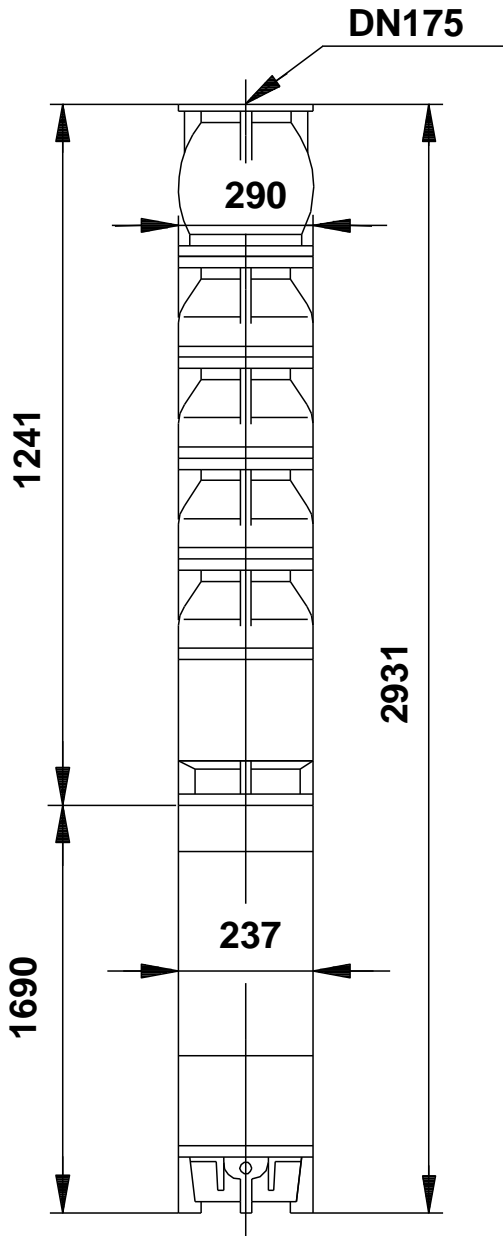

Note! All units are in [mm] unless others are stated.  
Disclaimer: This simplified dimensional drawing does not show all details.

**96431011 SP 360-3L G 50 Hz**

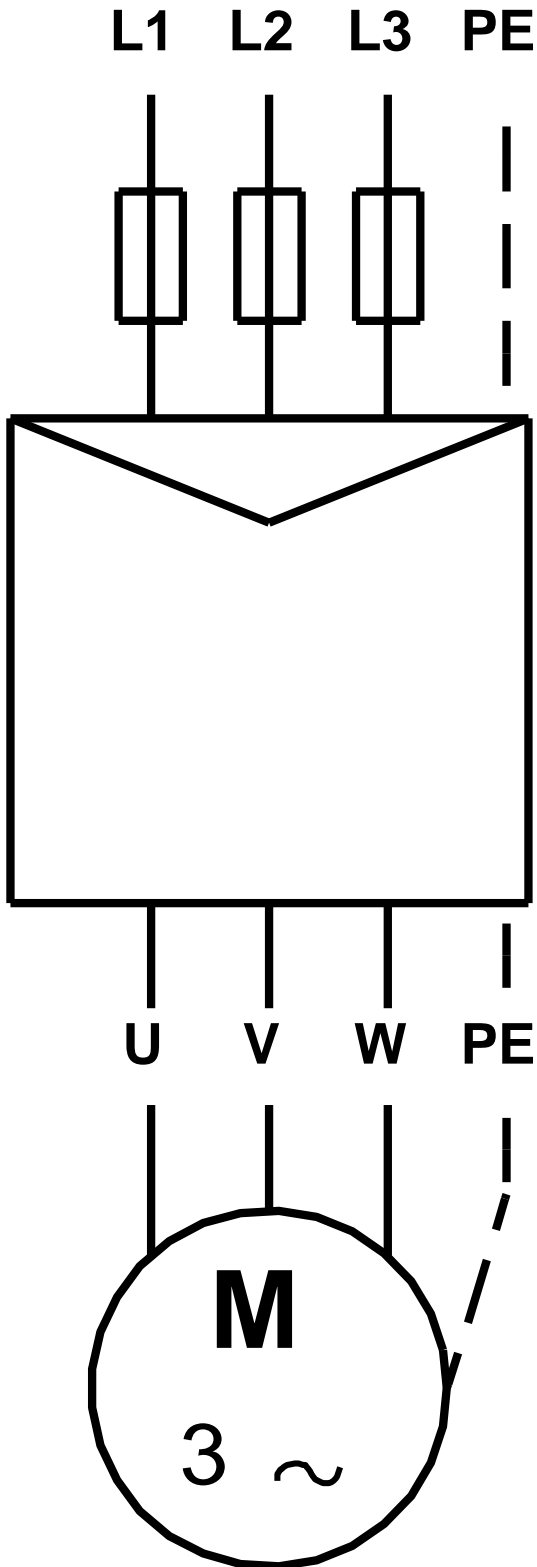

Note! All units are in [mm] unless others are stated.