

**Qty. Description**

1 **SP 300-4D G**



**Note! Product picture may differ from actual product**

Product No.: [96430994](#)

Multi-stage submersible pump for raw water supply, groundwater lowering, pressure boosting and various industrial jobs.

The pump is suitable for pumping clean, thin, non-aggressive liquids without solid particles or fibres.

**Pump:** The pump is made entirely of Cast iron DIN W.-Nr. EN-JL1040 and suitable for horizontal installation.

The pump is fitted with a built-in non-return valve.

**Phase:** The motor is a 3-phase motor with sand shield, liquid-lubricated bearings and pressure equalizing diaphragm.

Performance test according to ISO9906 2012 Grade 3B is available on request.

**Liquid:**

Pumped liquid: Water  
 Maximum liquid temperature: 40 °C  
 Max liquid t at 0.15 m/sec: 25 °C  
 Selected liquid temperature: 20 °C  
 Density: 998.2 kg/m<sup>3</sup>

**Technical:**

Type of impeller: D  
 Shaft seal for motor: CER/CARBON  
 Curve tolerance: ISO9906:2012 3B  
 Motor version: T30

**Materials:**

**Pump:** Cast iron  
 EN-JL1040  
**Impeller:** Zinc-free bronze  
 DIN W.-Nr. 2.1050.01  
**Motor:** Cast iron  
 DIN W.-Nr. 0.6025  
 ASTM 35-40

**Installation:**

Flange standard: DIN  
 Pump outlet: DN175  
 Motor diameter: 10 inch

**Electrical data:**

Motor type: MMS10000  
 Rated power - P2: 147 kW  
 Mains frequency: 50 Hz



Company name:

Created by:

Phone:

Date:

12/11/2020

| Qty. | Description   |
|------|---|
|      | <p>Rated voltage: 3 x 380-400-415 V<br/>Rated current: 315-315-320 A<br/>Cos phi - power factor: 0.85-0.81-0.77<br/>Rated speed: 2920-2920-2930 rpm<br/>Start. method: direct-on-line<br/>Enclosure class (IEC 34-5): IP68<br/>Built-in temp. transmitter: no<br/>Motor No: 96430681<br/>Windings: PVC</p> <p>Others:<br/>Net weight: 750 kg<br/>Shipping volume: 0.765 m<sup>3</sup><br/>Country of origin: IT<br/>Custom tariff no.: 84137029</p> |

## 96430994 SP 300-4D G 50 Hz

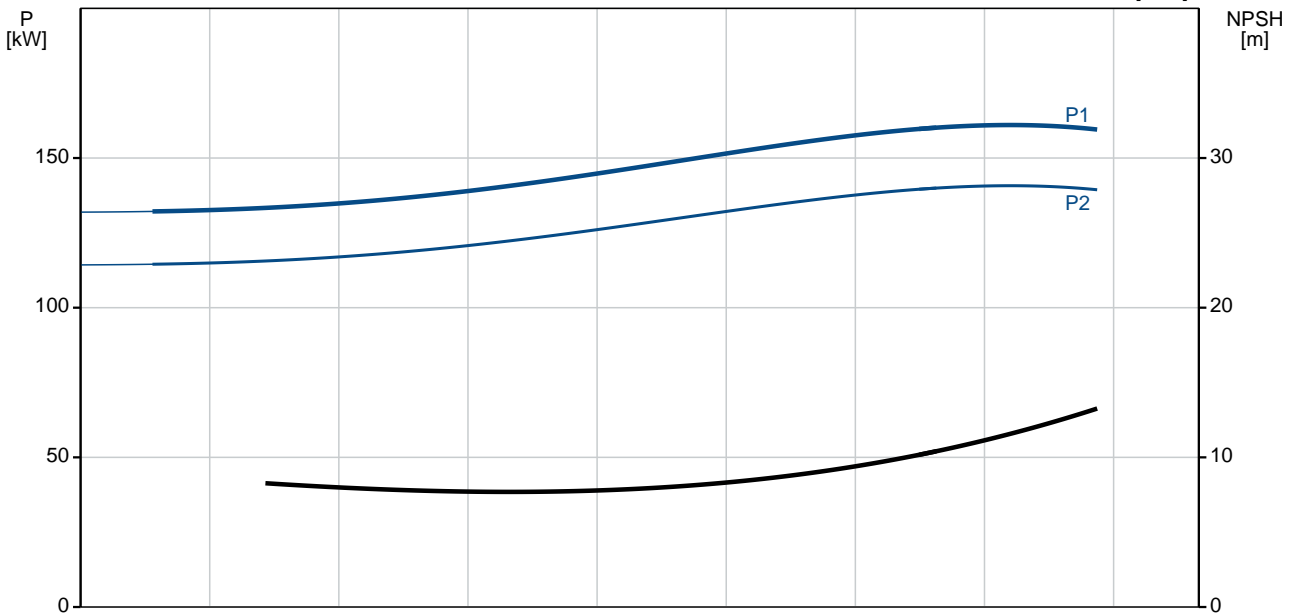
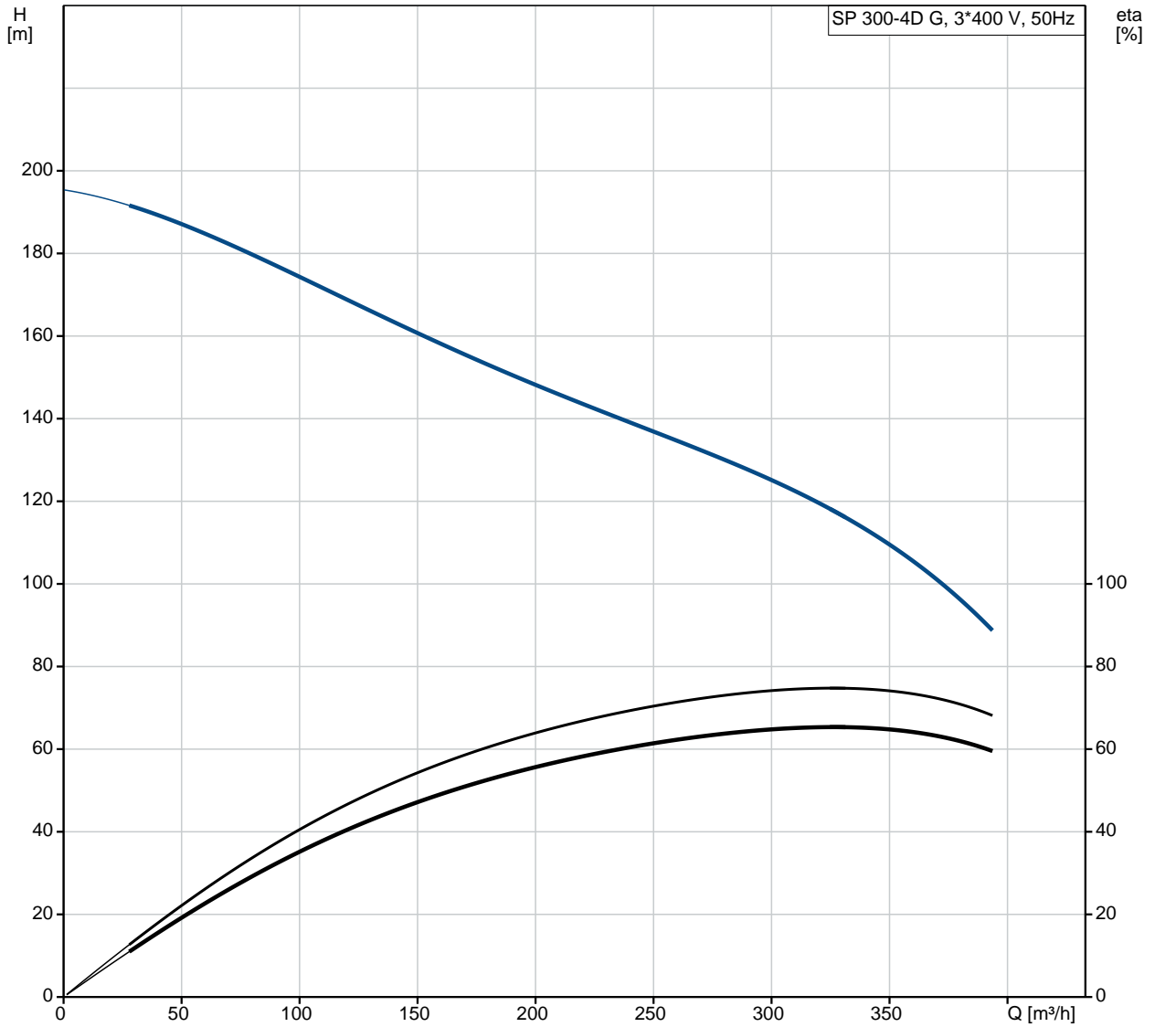

| Description                  | Value                               |
|------------------------------|-------------------------------------|
| <b>General information:</b>  |                                     |
| Product name:                | SP 300-4D G                         |
| Product No:                  | 96430994                            |
| EAN number:                  | 5700393033290                       |
| <b>Technical:</b>            |                                     |
| Stages:                      | 4                                   |
| Type of impeller:            | D                                   |
| Shaft seal for motor:        | CER/CARBON                          |
| Curve tolerance:             | ISO9906:2012 3B                     |
| Pump No:                     | 96430896                            |
| Valve:                       | pump with built-in non-return valve |
| Motor version:               | T30                                 |
| <b>Materials:</b>            |                                     |
| Pump:                        | Cast iron                           |
| Pump:                        | EN-JL1040                           |
| Impeller:                    | Zinc-free bronze                    |
| Impeller:                    | DIN W.-Nr. 2.1050.01                |
| Motor:                       | Cast iron                           |
| Motor:                       | DIN W.-Nr. 0.6025                   |
| Motor:                       | ASTM 35-40                          |
| <b>Installation:</b>         |                                     |
| Flange standard:             | DIN                                 |
| Pump outlet:                 | DN175                               |
| Motor diameter:              | 10 inch                             |
| <b>Liquid:</b>               |                                     |
| Pumped liquid:               | Water                               |
| Maximum liquid temperature:  | 40 °C                               |
| Max liquid t at 0.15 m/sec:  | 25 °C                               |
| Selected liquid temperature: | 20 °C                               |
| Density:                     | 998.2 kg/m <sup>3</sup>             |
| <b>Electrical data:</b>      |                                     |
| Motor type:                  | MMS10000                            |
| Applic. motor:               | GRUNDFOS                            |
| Rated power - P2:            | 147 kW                              |
| Mains frequency:             | 50 Hz                               |
| Rated voltage:               | 3 x 380-400-415 V                   |
| Rated current:               | 315-315-320 A                       |
| Cos phi - power factor:      | 0.85-0.81-0.77                      |
| Rated speed:                 | 2920-2920-2930 rpm                  |
| Start. method:               | direct-on-line                      |
| Enclosure class (IEC 34-5):  | IP68                                |
| Motor protec:                | NONE                                |
| Thermal protec:              | external                            |
| Built-in temp. transmitter:  | no                                  |
| Motor No:                    | 96430681                            |
| Windings:                    | PVC                                 |
| <b>Others:</b>               |                                     |
| Net weight:                  | 750 kg                              |
| Shipping volume:             | 0.765 m <sup>3</sup>                |
| Country of origin:           | IT                                  |
| Custom tariff no.:           | 84137029                            |

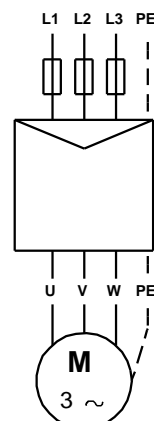
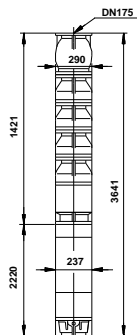
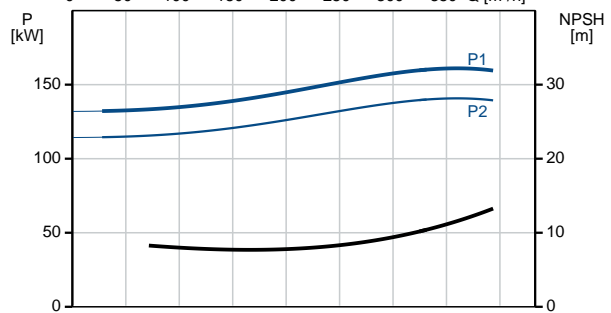
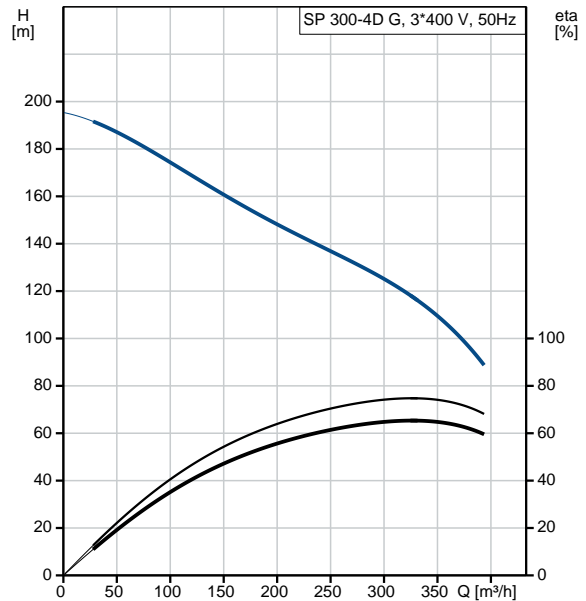

## 96430994 SP 300-4D G 50 Hz

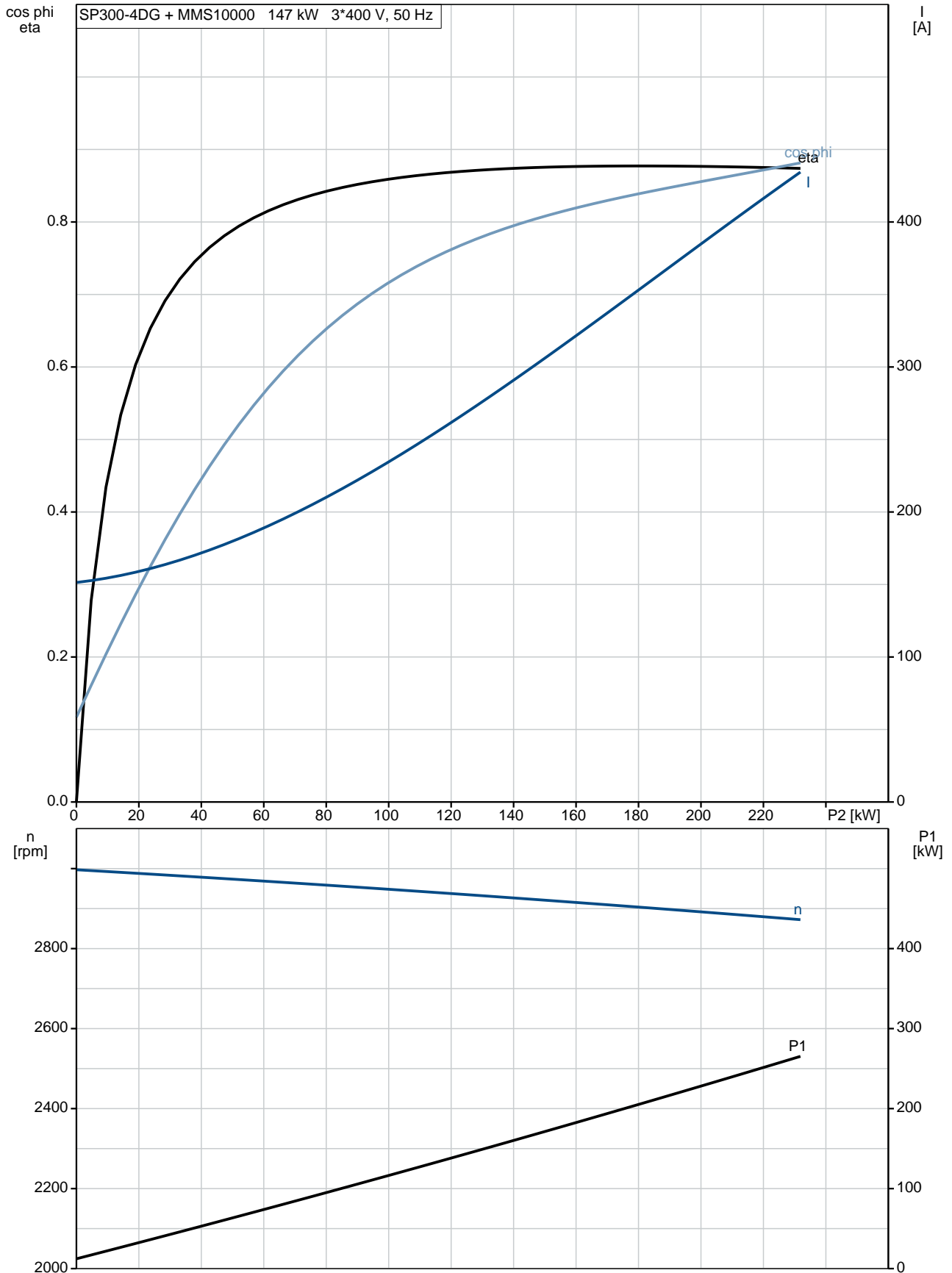

## 96430994 SP 300-4D G 50 Hz

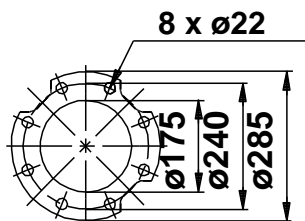
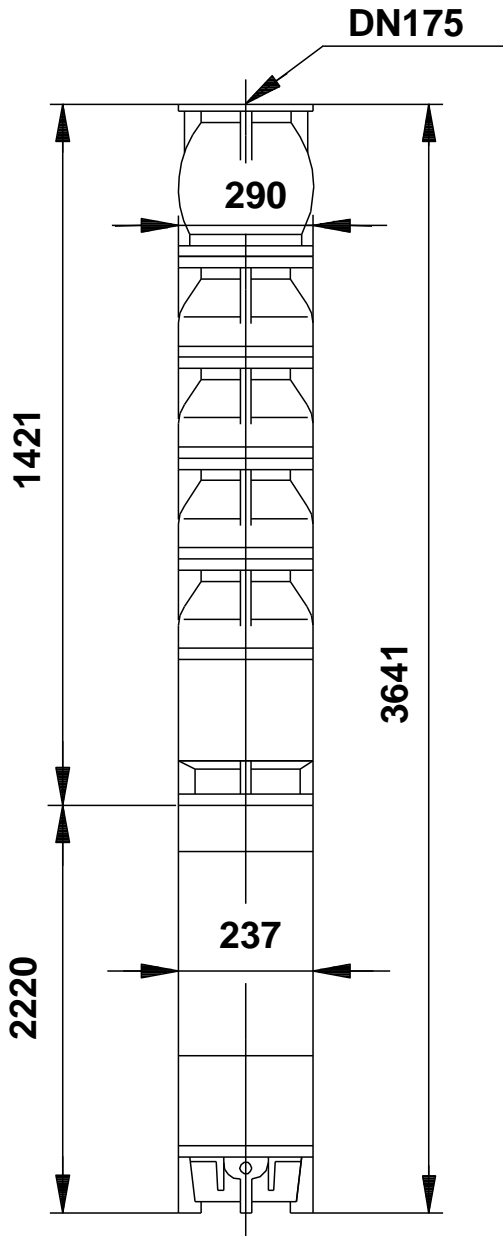

Note! All units are in [mm] unless others are stated.  
Disclaimer: This simplified dimensional drawing does not show all details.

96430994 SP 300-4D G 50 Hz



Note! All units are in [mm] unless others are stated.