

Position	Count	Description
	1	<p>SL1.50.65.15.2.50B</p>  <p>Product No.: 96104118</p> <p>Non-self-priming, single-stage, centrifugal pump designed for handling wastewater, process water and unscreened raw sewage.</p> <p>The pump is designed for intermittent and continuous operations in submerged installation. The revolutionary S-tube® impeller provides free spherical passage of solids up to 1 15/16 in and is suitable for wastewater with a dry matter content of up to 3 %.</p> <p>A unique stainless-steel clamp assembling system enables quick and easy disassembly of the pump from the motor unit for service and inspection. No special tools are required.</p> <p>Controls:</p> <p>Moisture sensor: without moisture sensors Water-in-oil sensor: without water-in-oil sensor</p> <p>Liquid:</p> <p>Pumped liquid: any viscous fluid Maximum liquid temperature: 104 °F Density: 62.29 lb/ft³</p> <p>Technical:</p> <p>Type of impeller: Single Channel Maximum particle size: 1 15/16 in Primary shaft seal: SIC/SIC Secondary shaft seal: LIPSEAL Approvals on nameplate: EN 12050-2 Curve tolerance: ISO 9906:2012 Grade 3B</p> <p>Materials:</p> <p>Pump housing: EN-GJL-250 EN-GJL-250 Impeller: EN-GJS500-7 EN-GJS500-7 Motor: DIN W.-Nr. GG20</p> <p>Installation:</p> <p>Maximum ambient temperature: 104 °F Pump inlet: 65 Pump outlet: 65 Maximum installation depth: 32.81 ft</p> <p>Electrical data:</p> <p>Power input - P1: 2.2 kW Rated power - P2: 2 HP Main frequency: 50 Hz Rated voltage: 3 x 400-415 V Voltage tolerance: +/-10 % Max starts per. hour: 30 Rated current: 3.8 A Rated current at 3/4 load: 3 A</p>



Company name:

Created by:

Phone:

Date:

11/13/2018

Position	Count	Description
		Rated current at 1/2 load: 2.4 A Starting current: 21 A Rated current at no load: 1.9 A Cos phi - power factor: 0.88 Cos phi - p.f. at 3/4 load: 0.81 Cos phi - p.f. at 1/2 load: 0.71 Rated speed: 2720 rpm Motor efficiency at full load: 67 % Motor efficiency at 3/4 load: 68 % Motor efficiency at 1/2 load: 63 % Start. method: direct-on-line Enclosure class (IEC 34-5): IP68 Insulation class (IEC 85): F Explosion proof: no Length of cable: 33 ft Cable type: H07RN-F Others: Net weight: 106 lb Country of origin: HU Custom tariff no.: 84137021

96104118 SL1.50.65.15.2.50B 50 Hz

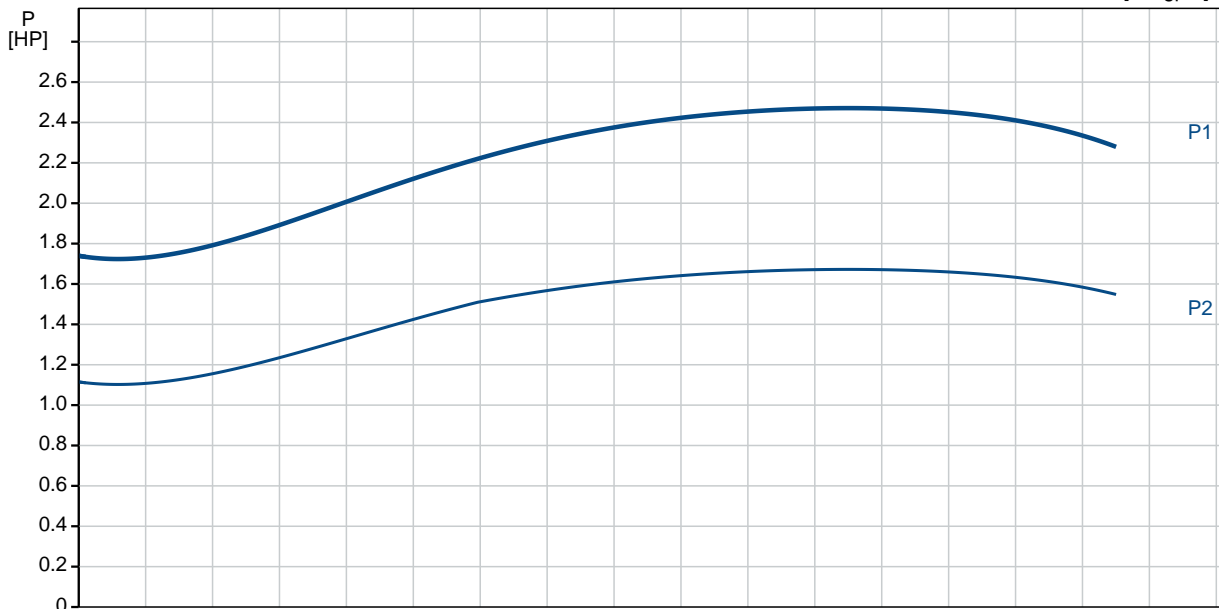
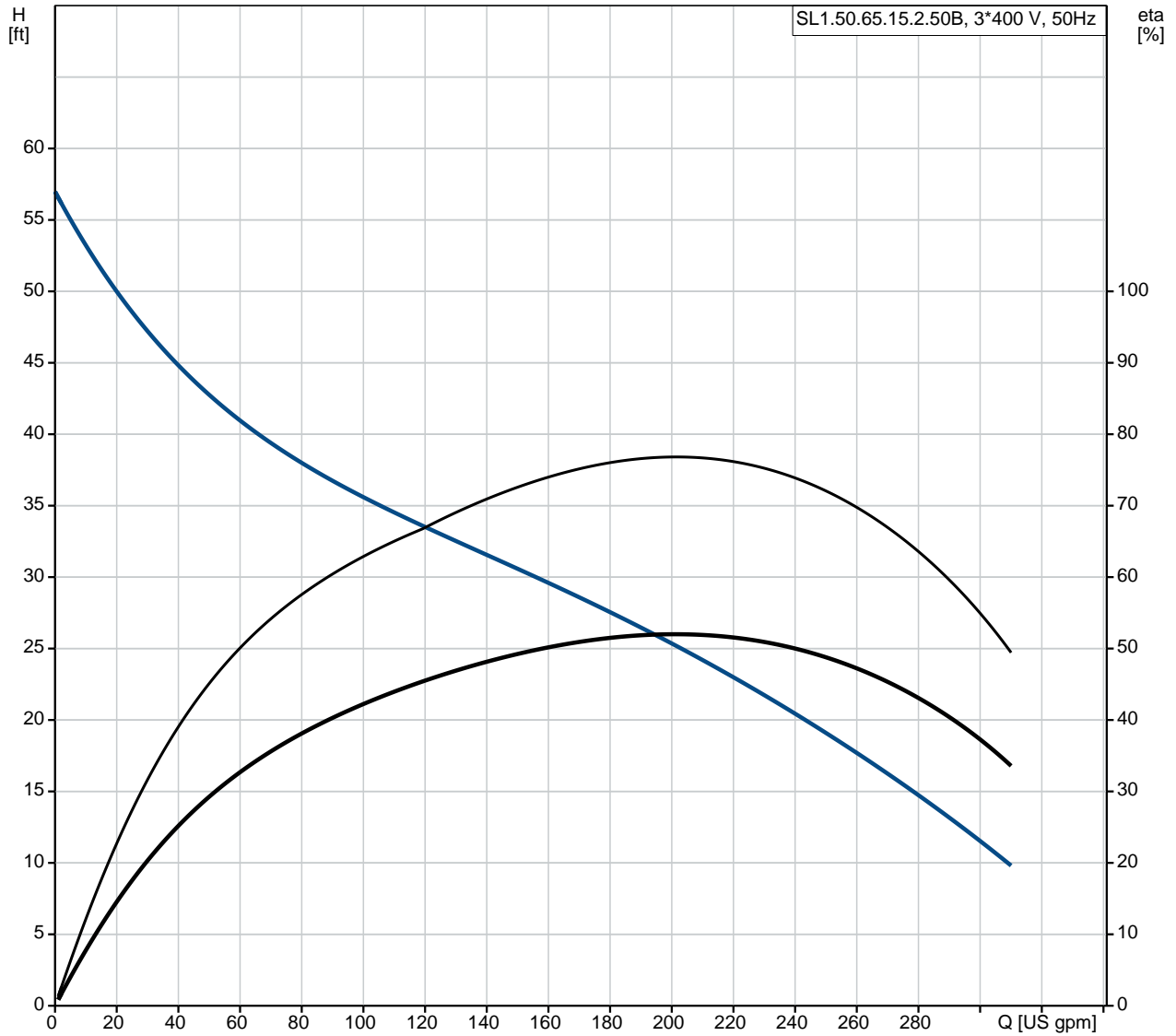

Description	Value
General information:	
Product name:	SL1.50.65.15.2.50B
Product No.:	96104118
EAN:	5700396424316
Technical:	
Max flow:	309 US gpm
Head max:	55.78 ft
Type of impeller:	Single Channel
Maximum particle size:	1 15/16 in
Primary shaft seal:	SIC/SIC
Secondary shaft seal:	LIPSEAL
Approvals on nameplate:	EN 12050-2
Curve tolerance:	ISO 9906:2012 Grade 3B
Cooling jacket:	without cooling jacket
Materials:	
Pump housing:	EN-GJL-250
	EN-GJL-250
Impeller:	EN-GJS500-7
	EN-GJS500-7
Motor:	DIN W.-Nr. GG20
Installation:	
Maximum ambient temperature:	104 °F
Pump inlet:	65
Pump outlet:	65
Maximum installation depth:	32.81 ft
Inst dry/wet:	SUBMERGED
Installation:	vertical
Liquid:	
Pumped liquid:	any viscous fluid
Maximum liquid temperature:	104 °F
Density:	62.29 lb/ft ³
Electrical data:	
Power input - P1:	2.2 kW
Rated power - P2:	2 HP
Main frequency:	50 Hz
Rated voltage:	3 x 400-415 V
Voltage tolerance:	+6/-10 %
Max starts per. hour:	30
Rated current:	3.8 A
Rated current at 3/4 load:	3 A
Rated current at 1/2 load:	2.4 A
Starting current:	21 A
Rated current at no load:	1.9 A
Cos phi - power factor:	0.88
Cos phi - p.f. at 3/4 load:	0.81
Cos phi - p.f. at 1/2 load:	0.71
Rated speed:	2720 rpm
Motor efficiency at full load:	67 %
Motor efficiency at 3/4 load:	68 %
Motor efficiency at 1/2 load:	63 %
Start. method:	direct-on-line
Enclosure class (IEC 34-5):	IP68
Insulation class (IEC 85):	F
Explosion proof:	no
Motor protection:	THERMAL SWITCH
Length of cable:	33 ft
Cable type:	H07RN-F
Controls:	

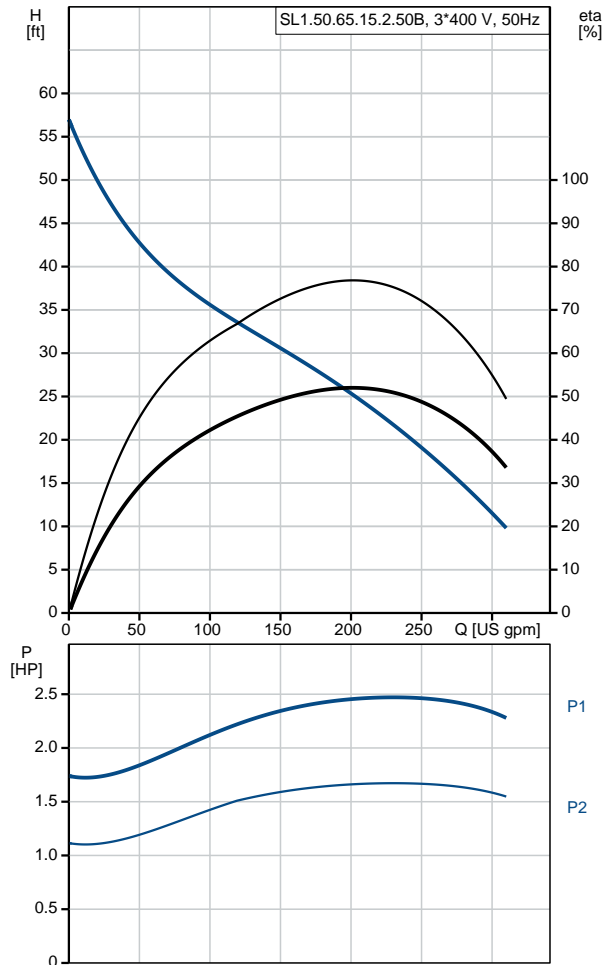



Company name:

Created by:

Phone:

Date:

11/13/2018

Description	Value
Control box:	not included
Moisture sensor:	without moisture sensors
Water-in-oil sensor:	without water-in-oil sensor
Others:	
Net weight:	106 lb
Country of origin:	HU
Custom tariff no.:	84137021

96104118 SL1.50.65.15.2.50B 50 Hz

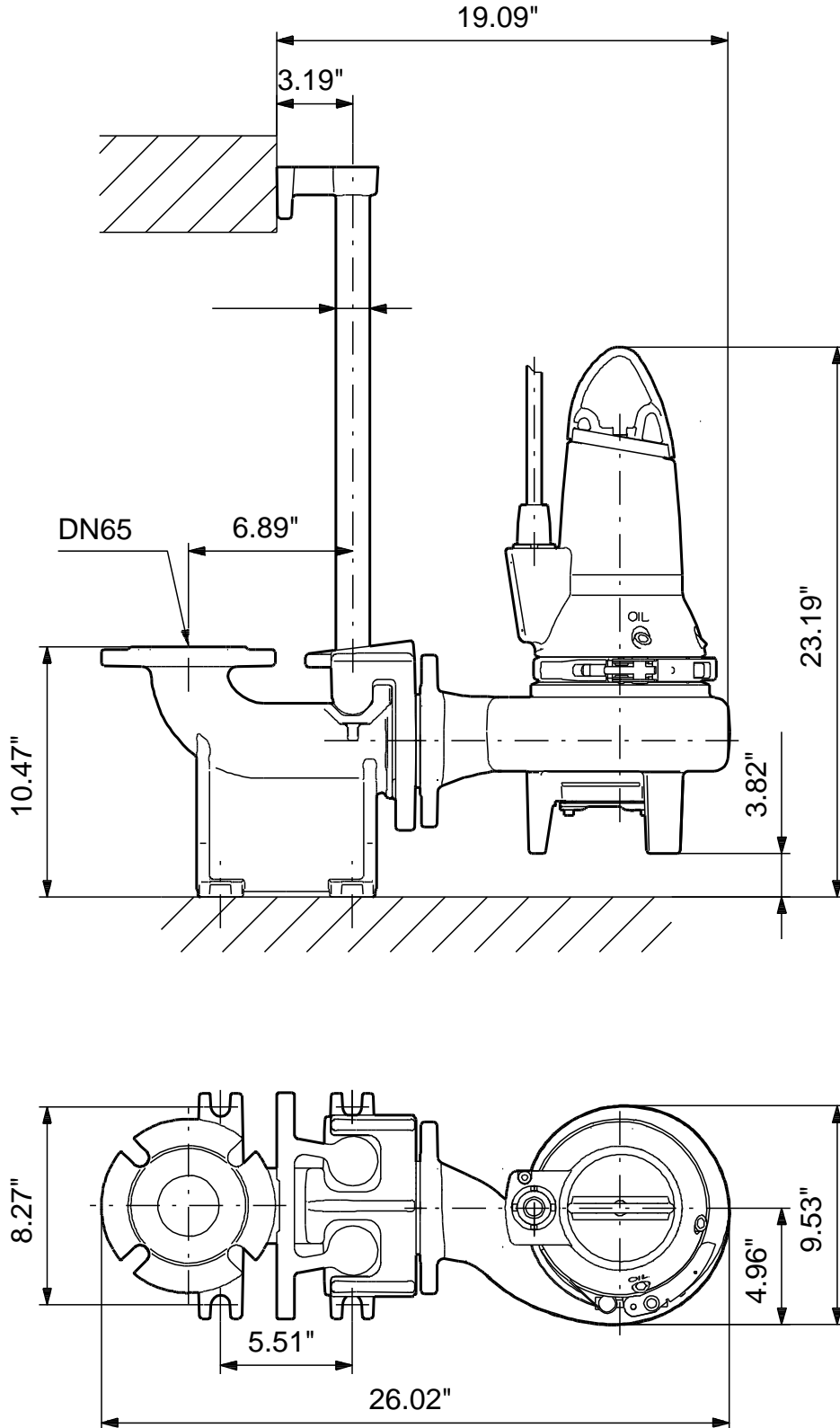

Note! All units are in [mm] unless otherwise stated.
Disclaimer: This simplified dimensional drawing does not show all details.

96104118 SL1.50.65.15.2.50B 50 Hz

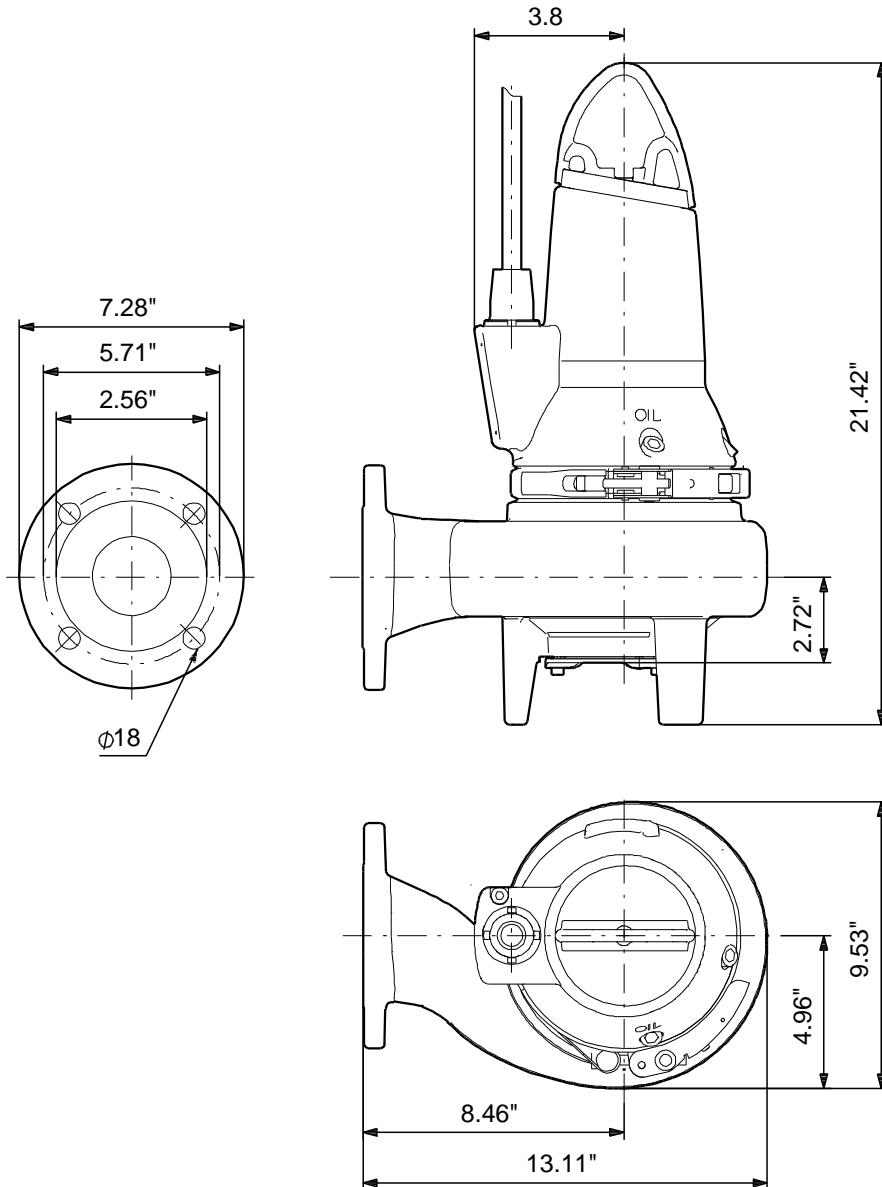

Note! All units are in [mm] unless otherwise stated.
Disclaimer: This simplified dimensional drawing does not show all details.

96104118 SL1.50.65.15.2.50B 50 Hz

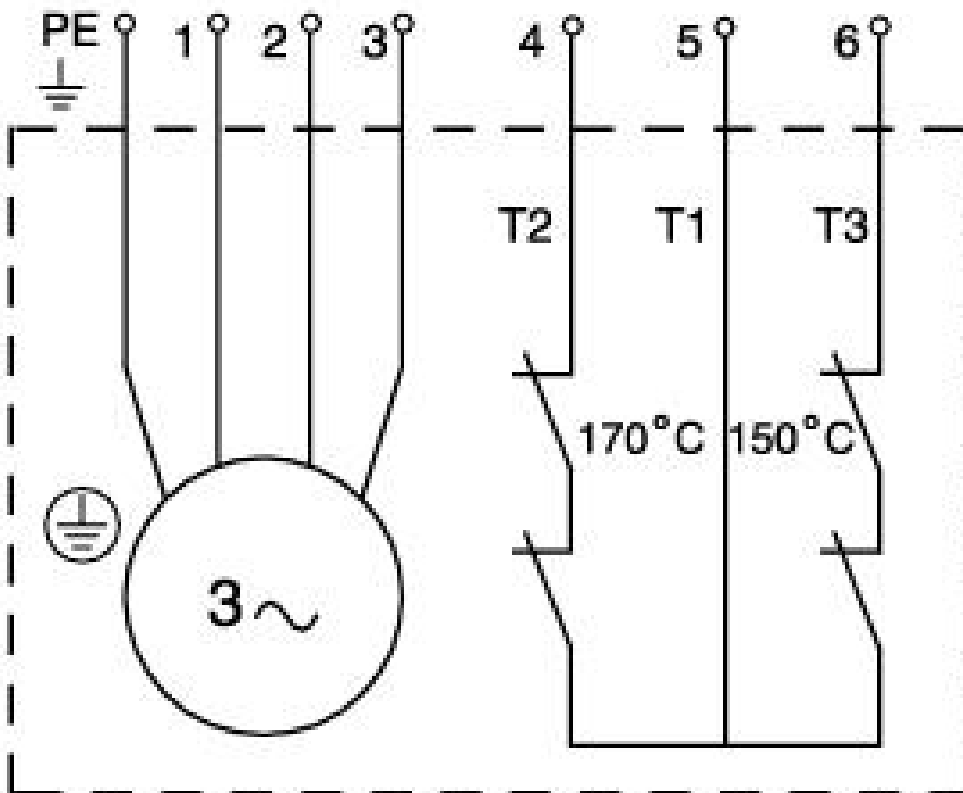
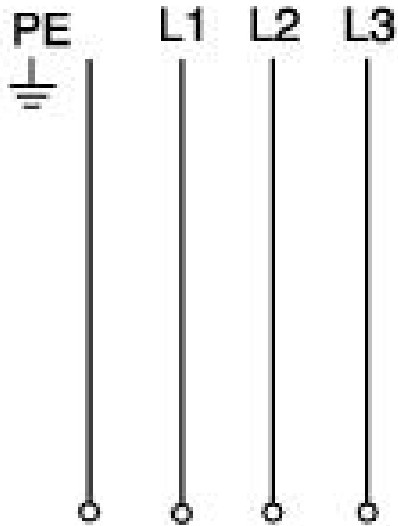

All units are [mm] unless otherwise presented.